

**President and CEO**

E. LeRoy "Toy" Nettles, Jr.

Chairman, Board of Trustees

James A. Goodson

Trustees

Jule Conner

Preston Gainey

David Howell

Louise Kelley

Hamer Parnell

Fred Riales

W. F. Rogers

LaShon Sellers

Don Teal

Pat Thomas-Toney

Office Hours

8 a.m.–5 p.m.
Monday–Friday

Corporate Headquarters

1355 East McIver Road
PO Box 491
Darlington, SC 29540

District Office

1811 North 501 Bypass
Marion, SC

Report Power Outage

(843) 665-4070
Toll-Free (866) 747-0060

Web site

PeeDeeElectric.com

Co-op News Editor

Tom Kinard



Your Touchstone Energy® Partner

In Line for Savings

Putting 'members first' for appliance rebates, beginning March 31.

WE CONSTANTLY SEEK WAYS TO HELP OUR members manage energy costs. Recent examples include the Together We Save and Help My House home energy efficiency initiatives.



Our latest effort is helping the State Energy Office get the word out about the upcoming Energy Efficient Appliance Rebate program. We want Pee Dee Electric Cooperative members to be the first in line to take advantage of these savings opportunities. And by savings we mean savings on the up front cost of a new appliance and, for the long-term, savings through the appliances' improved energy efficiency.

Here's how the program will work: South Carolinians who want to replace old household appliances with new, energy-efficient models could receive discounts of \$50 to \$500 beginning March 31 and continuing until all funds are exhausted.

The rebates for new Energy Star-certified refrigerators, dishwashers, water heaters and other appliances are funded by South Carolina's share of the \$300 million in federal stimulus funds being distributed to each state for appliance rebates. A total of \$3.9 million will be available in South Carolina for rebates.

For appliances bought in a store, the rebate will be applied instantly when the customer goes to the register. Installers of whole-house equipment such as water heaters and HVAC

systems will reserve rebates online and then provide customers with mail-in forms. An electronic system will track each rebate issued.

Don't miss out. The Energy Office, part of the S.C. Budget and Control Board, expects that interest will be high. Funds could be exhausted in a matter of weeks.

Rebate levels were determined based upon the cost difference between a standard and an Energy Star appliance. Energy Star-qualified appliances incorporate advanced technologies that use 10–50 percent less energy and water than standard models.

The rebates will be available only to South Carolina residents making purchases in South Carolina stores and contractors. Customers who purchase a new appliance must turn in the old item. Stores and contractors participating in the rebate program must agree to recycle all old appliances in accordance with standard industry practice. Recycling is required to ensure that inefficient appliances are removed from the power grid.

To learn more about the benefits of upgrading refrigerators, dishwashers and other appliances, click on TogetherWeSave.com.

James A. Goodson
Chairman, Board of Trustees

Appliance Rebates Begin March 31 Receive Up To \$500 From State

ON THE FACING PAGE, MR. JAMES GOODSON, CHAIRMAN OF THE BOARD, gave details of the Energy Efficient Appliance Rebate Program. Wednesday, March 31, is the start date for South Carolina residents to receive up to \$500 for purchasing new, Energy Star approved appliances like washers, refrigerators and heat pumps. Below is a list of eligible appliances and the rebates available:

APPLIANCE	REBATE
▶ Clothes Washer	\$100
▶ Dishwasher	\$50
▶ Refrigerator	\$50
▶ Room Air Conditioning Unit	\$50
▶ Central Air Conditioning Unit	\$200
▶ Heat Pump	\$500
▶ Electric Heat Pump Water Heater	\$400
▶ Solar Electric Water Heater	\$400

For complete details on the South Carolina Energy Efficient Appliance Rebate Program, please contact the South Carolina Energy Office in Columbia. On the Web at energy.sc.gov — click Stimulus Information — then Appliance Rebate Program or call toll-free 800-851-8899.

Please note: electric water heaters are not part of the SC Appliance Rebate Program, but Pee Dee Electric Cooperative members are encouraged to participate in the co-op's ongoing Water Heater Rebate Program. For complete information: on the Web at PeeDeeElectric.com or call 843-665-4070 or toll-free 866-747-0060.

Speaking of Water Heaters . . .

Jeff's Energy Tips in this edition is all about how to extend the life of your water heater and, by doing so, save money each month on your power bill. See page 20B.

Apply Today for WIRE Scholarship

THE PEE DEE ELECTRIC CHAPTER OF Women Involved in Rural Electrification annually gives two \$1,000 scholarships to deserving high school seniors to be used in their pursuit of higher education. The competition for the award is for dependents of PDEC members and is based on transcripts, ACT/SAT score, honors and activities, and letters of reference. Deadline for submission of application is April 7, 2010. The scholarships will be awarded during the WIRE dinner/meeting







A full size scholarship application is available online: PeeDeeElectric.com.



Apply Today for Washington Youth Tour



-  RISING HIGH SCHOOL JUNIOR
-  WANT AN ALL-EXPENSES PAID TRIP TO WASHINGTON, DC
-  WANT TO SEE THE SIGHTS
-  WANT TO MEET OUR REPRESENTATIVES
-  WANT TO LEARN OUR HISTORY

Complete details and downloadable application at PeeDeeElectric.com. Deadline to apply is Monday, March 1. The 2010 Youth Tour will be held June 12–17.



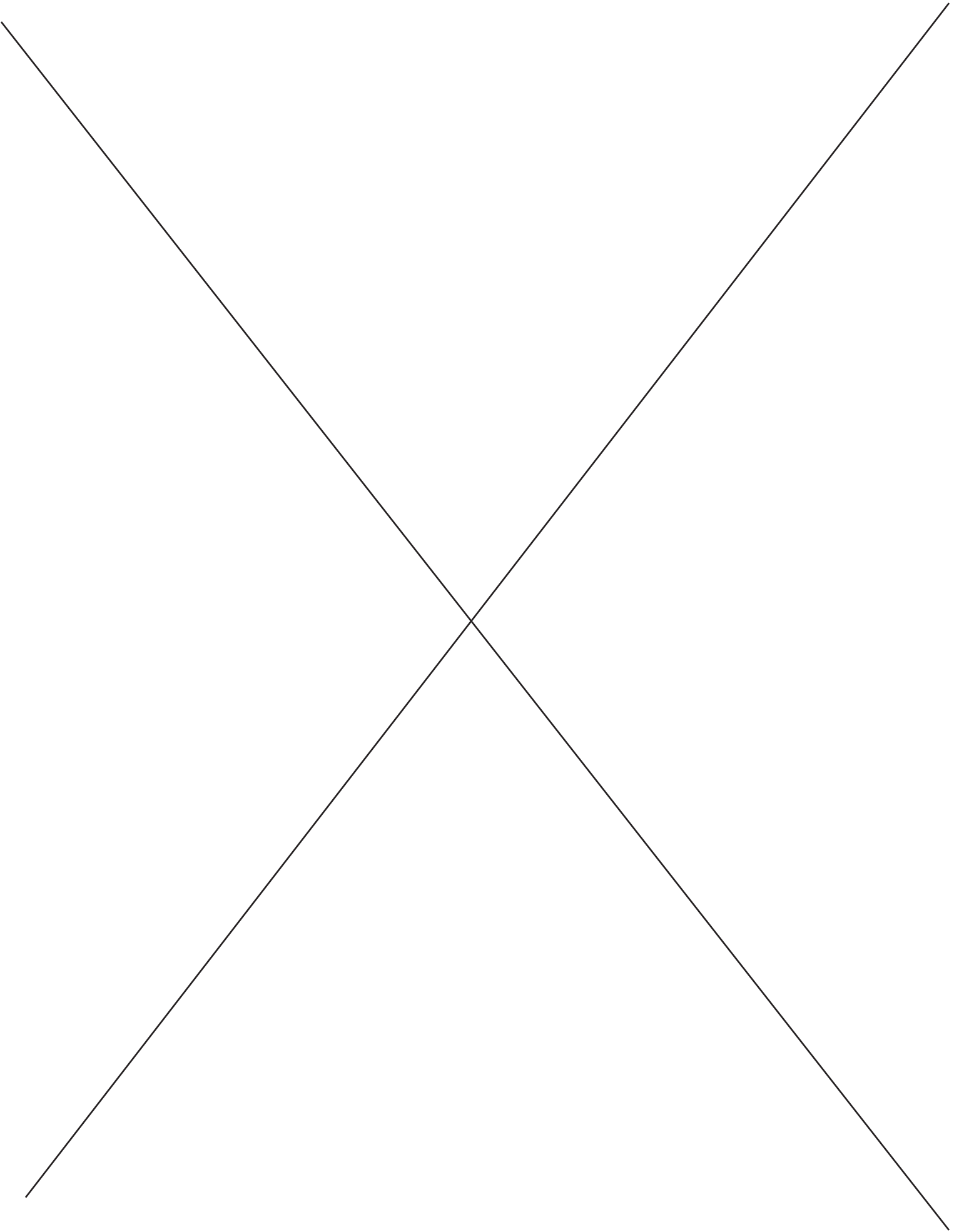

TOU (Time of Use) Is It For YOU?

PDEC Pilot Time-of-Use Rate Could Save On Your Energy Bill

ELECTRIC POWER, LIKE ALL THINGS GOVERNED BY THE LAWS OF SUPPLY AND demand, cost more at certain times than others. On a hot summer afternoon or a cold winter morning, it cost a lot more to supply those much-needed kilowatt-hours (kWh) to our members. Although the price PDEC pays for the energy we distribute fluctuates quite often, we have always attempted to hold the price we charge for that energy rather steady – for the sake of simplicity.

However, in this day of smart grids, programmable thermostats, electronic meters, and tech-savvy member-owners, we feel that we can now offer a rate structured like the one we pay. In order to take advantage of this rate, however, a customer would need to buy as much power off peak as possible. If customers can make this lifestyle change, they can actually save money by switching to this rate.

The first thing to understand is that the rate is entirely voluntary. No one is being switched to this rate unless they want to be. Another thing to keep in mind is the meters required to make this rate work are very complex ... and expensive. Because of this, we are planning to only try this out on the first 100 interested members. If the test group does well, we will expand the program.

So how does the time-of-use (TOU) rate work? The current rate that residential members pay for electricity is 12.31 cents per kWh – regardless of when the energy is used. Under the time-of-use rate, energy (kWh) is discounted most of the time – to 10 cents. However, during a few peak hours of the day (hot afternoons and cold mornings), energy comes at a premium – 20 cents per kWh. The actual times and dates are as follows:

Warm Weather (April 16 – October 15)
Peak Hours: 2 pm to 7 pm

Cold Weather (October 16 – April 15)
Peak Hours: 6 am to 9 am



Basically, if a member can make a conscious effort to shift usage to off-peak times, they can save a respectable amount of money each month on their power bill. For example, an average month's usage of 1500 kWh will yield a power bill of about \$185 on the normal residential rate. However, if a member with the same usage on the TOU rate is able to reduce 25% of the normal load they would have during peak hours and shift another 25% to an off-peak time, the bill should be reduced to approximately \$175 in the warmer months and \$170 in the winter months. That's \$10-\$15 savings each month (based on 1500 kWh usage) simply by changing the time you do laundry, take showers, wash dishes, etc.

A word of caution: If a member switches to the TOU rate and DOES NOT make these changes, the bill will most likely end up higher than normal. Furthermore, because these meters are significantly more expensive than regular meters, if a customer chooses to switch back to the normal residential rate in the first two years, a trip fee (currently \$30) will be assessed to cover the cost of swapping out the meter.

For these reasons, we ask that only those that are serious about trying to make this rate work for them apply for a spot on the trial run. Only 100 will be chosen. If you are interested, please call us for more details. 843-665-4070 or toll free 866-747-0060.

2010 WIRE Schedule

February 18 - Program: 2010 Census

May 20 - Program TBA

August 19 - Program TBA

November 18 - Thanksgiving Dinner

Women Involved in Rural Electrification is open, free of charge, to any female member of PDEC. Meetings begin at 6:00 pm in the Assembly Room of the Darlington Headquarters. First time attendees please contact Page Chestnut, 843-665-4070.



TOM KINARD/FILE

Jeff's Energy Tips

by

Jeff Singletary • PDEC Energy Expert

CAUTION

SCALDING HOT WATER

Be very careful and keep children and pets away during this procedure.

DRAINING YOUR WATER HEATER IS AN important part of home maintenance and is a lot easier than you may think. Water heater manufacturers recommend you drain your water heater periodically to keep sediment and deposits from building up. If left alone, these deposits tend to reduce efficiency and shorten the effective life of your water heater, plus it can actually reduce the amount of hot water available to your family, so it's good idea to spend a little time maintaining this important home appliance. How often your water heater needs to be drained is determined by the quality of your water. Areas with high mineral content require maintenance to water heaters more often. As you drain the water heater, you'll also be flushing the sediments and deposits out.

Now, let's get started. Follow these simple steps to

cleaner, cheaper and more hot water.

- ▶ Caution: Read all safety information that came with your water heater before attempting any kind of maintenance.

- ▶ In addition to the items listed in the "You Will Need" box, be sure you wear heavy gloves and eye protection. The water draining will be hot, so protect yourself from burns.

- ▶ Cut off the electricity to the water heater at the breaker box. Make sure the power is OFF before continuing. Draining the water without cutting the power and the heating element(s) will continue to get hot and burn themselves out.

- ▶ Attach the garden hose to the drain valve at

the bottom of the water heater. Be sure you have enough hose to reach outside and away from children and pets. The water will be very hot and can scald. It's not a good idea to let the water drain onto the lawn as the hot water and the sediments will probably kill the grass. A ditch or paved driveway will work much better.

- ▶ Close the shut-off valve on the cold water inlet to the water heater.

- ▶ Carefully open the pressure relief valve on the top of the water heater

by lifting the lever. Leave the valve open.

- ▶ Open the drain valve at the bottom of the water heater. If the sediment is clogging, close the pressure relief valve and re-open the cold water inlet valve. This will "power-flush" the deposits.

- ▶ When the water runs clean from the garden hose, you're finished.

- ▶ Close the valve at the bottom and remove the garden hose. If still open, close the pressure relief valve and turn on the cold water inlet valve.

- ▶ Open a hot water faucet in your house to prevent a vacuum.

- ▶ Call me with questions. 843-665-4070 or toll free 866-747-0060.

You will need

Garden Hose

Screw Driver

Slip-joint Pliers

Have a Portable, Electric Generator?

PLEASE • Be Careful!

Portable electric generators offer great benefits when outages affect your home. Here are some guidelines for safe operation.

The only safe way to connect a portable electric generator to your existing wiring is to have a licensed electrical contractor install a transfer switch. The transfer switch transfers power from the utility power lines to the power coming from your generator.

Connecting a portable electric generator directly to your household wiring can be deadly to you and others. A generator that is directly connected to your home's wiring can "backfeed" onto the power lines connected to your home. Utility transformers can then "step-up" or increase this backfeed to thousands of volts - enough to kill a utility lineman making outage repairs a long way from your house. You could also cause expensive damage to utility equipment and your generator.

Never plug a portable electric generator into a regular household outlet. Plugging a generator into a regular household outlet can energize "dead" power lines and injure neighbors or utility workers. Connect individual appliances that have their outdoor-rated power cords directly to the receptacle outlet of the generator, or connect these cord-connected appliances to the generator with the appropriate outdoor-rated power cord having a sufficient wire gauge to handle the electrical load.



- ▶ **Don't overload the generator.**
- ▶ **Never use indoors or in an attached garage.**
- ▶ **Use the proper power cords.**
- ▶ **Don't run cords under rugs.**
- ▶ **Read and adhere to manufacturer's instructions.**
- ▶ **Don't cut corners when it comes to safety.**
- ▶ **Use proper grounding.**
- ▶ **Carefully read and observe all instructions in your owner's manual.**
- ▶ **Do not store fuel indoors or try to refuel a generator while it's running.**
- ▶ **Properly shut down the generator.**
- ▶ **Avoid getting burned.**
- ▶ **Keep children away from generator at ALL times.**

For specific questions concerning the operation of your generator, please refer to your owner's manual or contact the manufacturer.

For general questions about portable, electric generators, please call 843-292-4349 or toll free 866-747-0060.

When you leave a room...

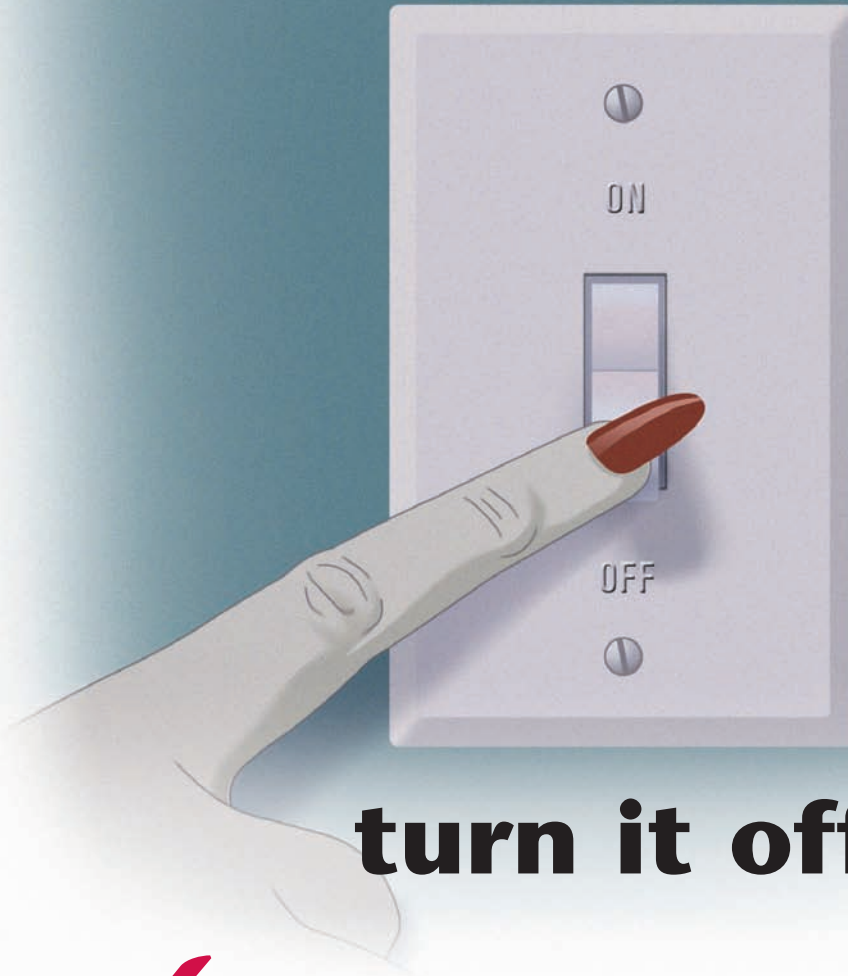

turn it off!

✓ Leaving incandescent bulbs on when you aren't there produces heat and wastes electricity.

✓ Switch to compact fluorescent bulbs (CFLs), which are four times more energy efficient than incandescent bulbs and last up to 10 times longer. Learn more at DoTheLightSwitch.com

Electricity is more valuable than ever.

Don't waste it.

Pee Dee Electric Cooperative is committed to work with integrity and innovation to provide you with reliable power at the best possible price.

✓ Turn off or unplug electronics such as cell phone chargers, home entertainment equipment and computers when not in use.



Your Touchstone Energy® Partner 

Visit PeeDeeElectric.com for more energy saving tips.

843-665-4070

866-747-0060 Toll Free